

MICRONECTOR 200 HIGH DENSITY 2MM PITCH CONNECTORS

A range of high specification 2mm pitch connectors meeting demanding performance requirements.

KEY FEATURES:

- 2mm pitch
- High reliability circular contacts for increased vibration and shock resistance
- Connector polarisation
- Small footprint for increased packing density
- Low profile
- 7 Sizes single row (2 to 17 way)
- 11 Sizes two row (4 to 34 way)
- Positive latching available
- Male straight and 90° p.c. terminations
- Female straight p.c. and crimp terminations

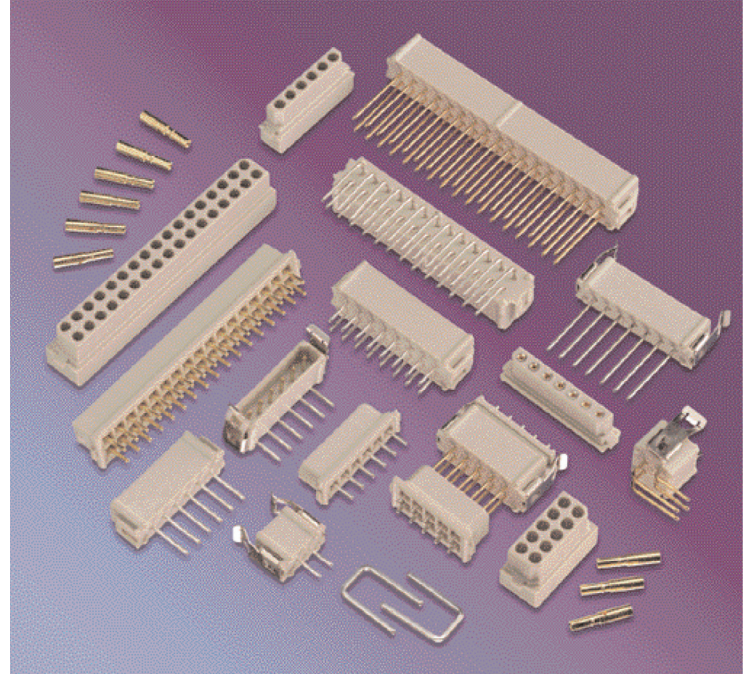

CRIMP DETAILS

Preferred wire type BS G 210 (Type A) *Also suitable for use with 24 AWG DEF-STAN 61-12 (Part 6 Type 1) PVC

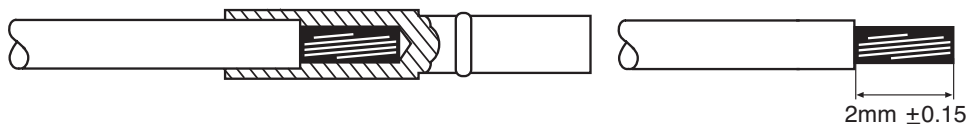

Termination Type	Crimp barrel accomodation	Wire Size/Crimp Tool Setting			
		22 A.W.G.	24 A.W.G.	26 A.W.G.	28 A.W.G.
C*	24-28 A.W.G.	—	7	6	6
D	22 A.W.G.	6	—	—	—

MINIMAL GAP EXTRACTION CLAW



FEMALE STRAIGHT P.C. TERMINATION TYPE T AND N

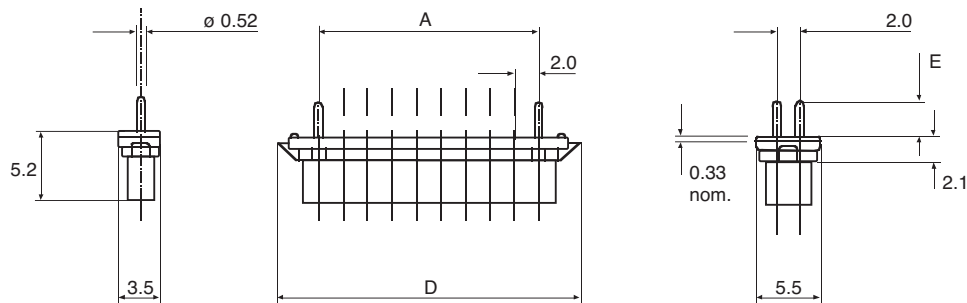

PCB LAYOUTS FOR MALE CONNECTORS TYPE L

for Male and Female Types T, X, Y and N omit 1.1/1.0mm holes

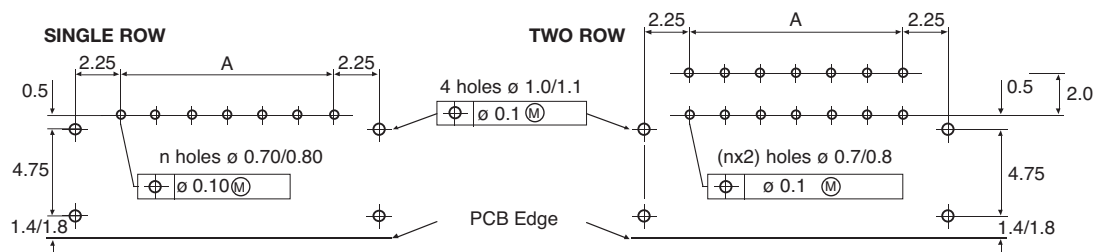

Contact Arrangement Single Row	2	3	4	5	6	7						17
Contact Arrangement Two Row	4	6	8	10	12	14	16	18	20	26	34	
A	2.0	4.0	6.0	8.0	10.0	12.0	14.0	16.0	18.0	24.0	32.0	
B	7.6	9.6	11.6	13.6	15.6	17.6	19.6	21.6	23.6	29.6	37.6	
C	8.1	10.1	12.1	14.1	16.1	18.1	20.1	22.1	24.1	30.1	38.1	
D	7.3	9.3	11.3	13.3	15.3	17.3	19.3	21.3	23.3	29.3	37.3	
Termination Type	T				Y		X				N	
E (nom.)	2.9				5.35		9.35				1.1	

Plug viewed from above, socket viewed from below

ORDERING INFORMATION

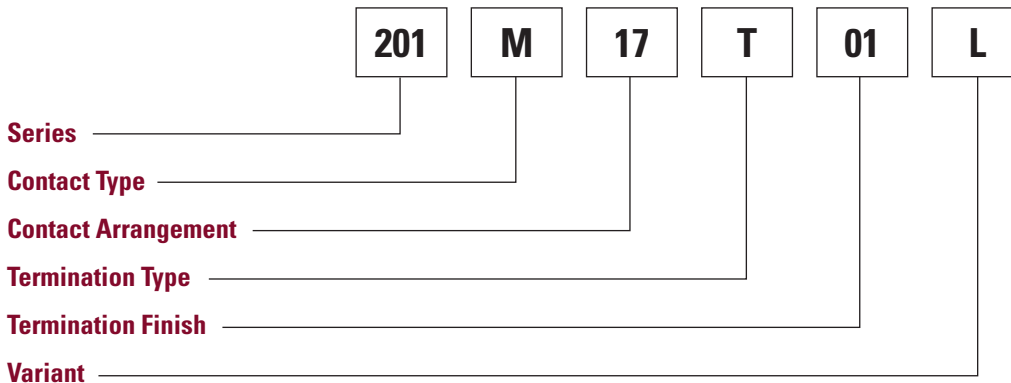
**Series**

201 – Single Row
202 – Two Row

Contact Type

M – Male
F – Female

Contact Arrangement

Single row – 02, 03, 04, 05, 06, 07 and 17
Two row – 04, 06, 08, 10, 12, 14, 16, 20, 26 and 34

Termination Type

L – 90° p.c. (male only)
T – Straight p.c. (male & female)
Y – Straight p.c. (male only)
X – Straight p.c. (male only)
N – Straight p.c. (short female only, for flexible circuits)
C – Crimp 24-28 A.W.G. (female only)
D – Crimp 22 A.W.G. (female only)

Termination Finish

01 – Gold
03 – Tin alloy

Variant

U – No Latches
L – Latches

MECHANICAL /
ELECTRICAL /
CHARACTERISTICS:**Insulator:**

Glass filled thermoplastic
rated UL94V-0

Contact:

Copper alloy plated hard acid gold

Termination:

Hard acid gold or tin/lead

Mechanical operations:

500

**Insertion and withdrawal force
(per contact pair):**

2.0N max., 0.2N min.

Contact retention:

10N min.

Crimp barrel accommodation:

22 AWG – 28AWG to BS G 210 type A

Current – individual contact**(in isolation):**

at 25°C Tamb 2.0A max
at 85°C Tamb 1.75A max

- all contacts (simultaneously):

at 25°C Tamb 1.75A max
at 85°C Tamb 1.5A max

Working voltage (DC or AC peak):

120V

Proof voltage (DC or AC peak):

360V

Contact resistance - (initially):

20mΩ max

- (after conditioning):

25mΩ max

Insulation resistance – (initially):

1000mΩ min

- (after conditioning):

100mΩ min

Temperature Range:

-55°C to +125°C

Vibration severity (General):

10 Hz, 2000Hz 0.75mm/98m/
s² (10g_n) duration 6h

Bump severity:

390m/s² (40g_n) 4000 ±10 bumps

Shock:

981m/s² (100g_n), for 6ms

Acceleration severity:

490m/s² (50g_n)

CONTACT ARRANGEMENT (VIEWED FROM MATING FACE OF MALE CONNECTOR)

